

Dfendoor

Double Swing Ambulant WC Door Systems

DSDA

- Dfendoor
- Single Door
- Double Swing
- Ambulant WC

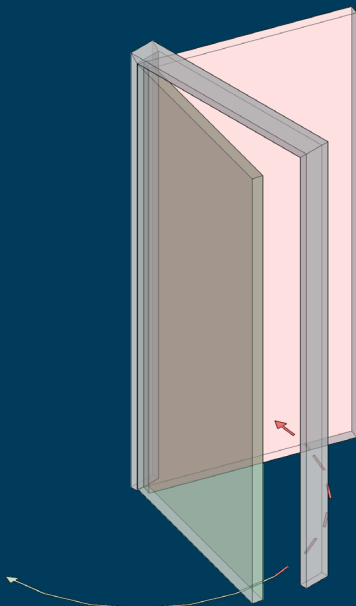

DUDA

- Dfendoor
- Unequal Pair
- Double Swing
- Ambulant WC

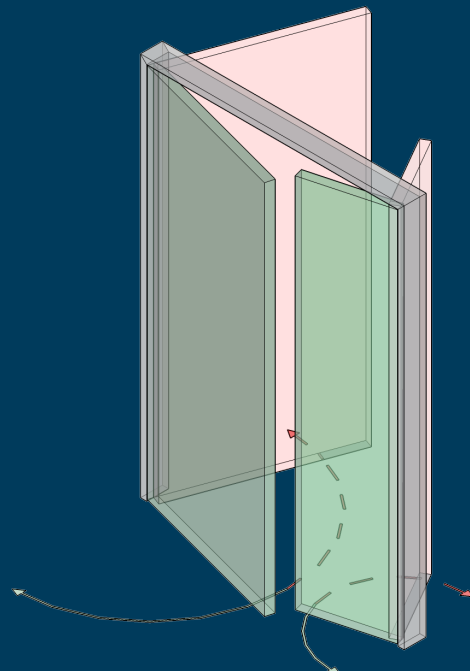

SDS Door Systems Explained

Every year thousands of brand-new fire doors have their certification invalidated from the moment they are fitted! Mostly this happens inadvertently but is hardly surprising when you consider that a compliant fire door is not just a door and frame. In order for a fire door to be compliant – the door leaf, the glazing, the door frame, the ironmongery, the fixings, the fire stopping materials, the intumescent products and the fire signage must not only be compatible, but must also be backed up with fire test evidence to prove the use of all components when fitted together. The most common mistake amongst the fire industry is to assume that an individual component with fire test evidence can automatically be fitted to a fire door. Sadly, this is not the case, and as a result many fire doors – although they are made up of fire rated components – are not fire compliant as a complete assembly.

At Specialist Door Solutions, we have created a number of Door Systems which have been compiled based on our experience in the industry and are designed to offer a one-stop solution for compliant high-performance doorsets comprising of doors, frames, vision panels and ironmongery solutions, all of which are fully backed up by the relevant test data and certification.



The DSDA & DUDA Door Systems

The **DSDA & DUDA** Door Systems are designed specifically for inward opening Ambulant WC's. These systems are designed to allow the door to swing outwards in the event of a patient falling or requiring assistance. An inward opening door would often restrict this from being possible, so the option to open the door outwards is extremely critical, as outlined in Building Regulations Approved Document M.

The **DSDA & DUDA** Door Systems are all part of the Dfendoor range of doors. The SDS Dfendoor is an incredibly resilient, hard wearing and hygienic doorset, ideal for high-traffic, high-wear hospital environments. As well as being extremely tough, with minimal maintenance requirements compared to timber and laminate products.

The SDS Dfendoor range has a very comprehensive range of glazing options, colour options, door leaf sizes, and also offers the ability to customise with items such as edge protectors and kickplates. These details are explained in more detail in the following pages.

Operational / Warranty

An incredibly resilient, hard wearing, and hygienic doorset. Dfendoor doors are supplied encapsulated with 2mm thick PVC, and are designed for high use in healthcare, pharmaceutical, hospitality, retail and education sectors. Supplied with 5 Year Warranty.

Fire Rating Options

NFR – No Fire Rating

FD30 – 30 Mins Fire Resistance

FD30s – Not available on double swing doors

FD60 – 60 Mins Fire Resistance

FD60s – Not available on double swing doors

Acoustic Performance

0 – 20dB – without any acoustic seals

21+ dB – Not available on **DSDA** or **DUDA** systems

Enviromental

Formaldehyde Release Rating Class E1, according to BS EN 13986 (2004).

FSC Certified – Certificate Registration No. SA-COC-005235.

Durability

Severe Duty Rating. All door cores have been tested to 1,000,000 cycles to BS EN 1191 (with classification according to BS EN 12400). This is the highest grading possible in the British Standard of Mechanical Tests for 'hinged or pivoted doors'. Judged on how they perform in tests, door assemblies are awarded one of four classifications, ranging from Light, Medium or Heavy to Severe Duty. In independent tests, These door cores achieved SEVERE DUTY – the highest grading possible in the British Standard of Mechanical Tests for 'hinged or pivoted doors'.



Maximum Leaf Sizes

Here are the maximum leaf sizes available for the **DSDA & DUDA** Door systems. These sizes are based on our primary fire test evidence.

Maximum sizes are noted for both the Width and Height of the door, as the width and height of a door are relative to each other. A very wide door is restricted by height, and a very tall door is restricted in width.

When a fire test is carried out – a door without a lock or latch is considered more onerous than a door with a latch. The reason for this is that the latch serves to hold the door in the closed position against the pressure build up within the furnace. This therefore creates two categories of permissible door sizes – those tested with a latch and those tested without a latch. All **DSDA & DUDA** door systems are designed to include a latch. Therefore the sizes below reflect this:

Note: DUD door sizes refer to the main leaf		Widest Option:		Tallest Option:	
		Height	Width	Height	Width
DSDA Doors 	NFR - With Latch	3000	1180	3000	1180
	FD30 - With Latch	2360	1180	2982	1075
	FD60 - With Latch	2360	1129	2569	1028

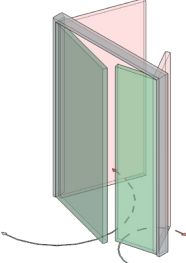
DUDA Doors 	NFR - With Latch	3000	1180	3000	1180
	FD30 - With Latch	2360	1180	2832	1075
	FD60 - With Latch	2360	1079	2469	1028

Vision Panels

No Vision Panel options are available on the **DSDA & DUDA** door systems as theses systems are intended for WC's.

Door Edges

All door edges on the **DSDA & DUDA** Door Systems are Postformed. This means that the PVC sheets on the faces of the doors are heated up and formed around the edges of the door. This provides the ultimate solution for both impact protection and hygiene, as there are no joints, no unprotected edges, and no loose components. The joint between the two faces of PVC is fitted with an intumescent strip.

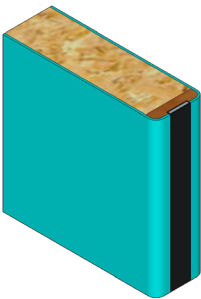

Frame Types

The following frame type is used on the **DSDA & DUDA** Door Systems;

Frame Type	Image	Comments	Notes	Wall Depths
Double Swing Offset		A Traditional style frame with separate architraves.	This type of frame is designed specifically for the DSDA & DUDA door systems. The door sits flush with the face of the frame rather than centrally like other double swing doors, and is designed to allow an Emergency Release Door Stop to be fitted within the frame reveal to allow the door to open in reverse in the event of an emergency. Frame fixings are normally placed within the intumescent groove, and the architraves are supplied with loose PVC covers to conceal fixings, thus giving a completely fixing-free finish.	90 – 190mm Extension lining available for reveals deeper than 190mm.

Finishes

All of the following colours are available on the **DSDA & DUDA** Door Systems. Doors and frames can be in the same colour, or in contrasting colours.

Woodgrains



American Black Walnut: LRV 40



Swiss Elm: LRV 22



American White Oak: LRV 43



Ellmau Beech: LRV 46



Trojan Oak LRV 37

DFend - Textured Finish



Denim: LRV 41



Buttermilk: LRV 69: RAL 1015

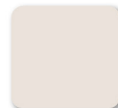

Mushroom: LRV 68: RAL 1013

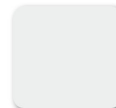

Chalk: LRV 78: RAL 9001



Snowflake: LRV 81: RAL 9003



Lupin: LRV 23: RAL 5024



Flint: LRV 21: RAL 7037



Gunpowder: LRV 51: RAL 7035



Cobble: LRV 36: RAL 9006



Carbon: LRV 22



Midnight: LRV 5: RAL 5003

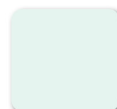

Peppermint: LRV 49



Jade: LRV 36

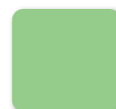

Verdure: LRV 56



Aqua: LRV 20: RAL 6033



Claret: LRV 8: RAL 3032



Grape: LRV 22: RAL 4008



Mandarin: LRV 33



Primrose: LRV 65

Ironmongery Sets

There's no hiding it - ironmongery is sometimes one of the most complicated aspects of a doorset. Apart from ensuring all components of an ironmongery set are compatible - there's also Fire Regulations, Fire certification, HTM compliance, DDA compliance and Building Regulations to consider!

Here at Specialist Door Solutions we have combined our many years of experience with doors and ironmongery in the healthcare sector, and created an industry pioneering range of 'Standard Ironmongery Sets'. All of these standard sets are 100% compliant with all of the above mentioned regulations, and are designed to take the hard work out of choosing ironmongery - whilst still offering a huge range of options.

Here's a few notes about what's in these sets, and on the following pages you will find full details of the ironmongery sets, listed under the relevant Door Systems.

Ironmongery Finishes

We offer our ironmongery sets in 3 finishes - each designed to offer different levels of hygiene. All of these different finishes are brushed stainless steel in appearance making them visually the same. This makes it possible to mix-and-match different ironmongery finishes in different areas of a project, according to the clinical sensitivity of the room/area.

• Define Range - Stainless Steel

Made from Stainless Steel - this is our Go-To option for most doorsets. Stainless Steel is extremely tough and offers excellent corrosion resistance to most oxidising acids making it easy to sanitise - ideal for the rigorous demands of hospital environments.

• Define⁺ Range - Anti-Microbial

A range of ironmongery with an Anti-Microbial coating containing silver ions. The silver ions in the coating continuously fight against harmful bacteria by disrupting the bacteria's metabolism which inhibits its survival and reproduction. The coating is extremely tough and remains operative even when subjected to the normal cleaning regimes of a hospital. Note - only 'touch-point' items will be coated. This includes Pull Handles, Push Plates, Lever Handles, Escutcheons and Bathroom Thumbturns. Where an ironmongery set is specified as Anti-Microbial, all 'non-touch-point' items will be Stainless Steel. Please also note, Digi-Locks are not available in Anti-Microbial finish.

• Define Copper Range - Copper Nickel

A range of ironmongery made from solid copper alloy. The key difference with this range is that it is not coated - it is made from solid copper alloy which continuously kills 99.9% of harmful bacteria, whilst maintaining the clinical aesthetic of stainless steel. Copper is the first and only elemental solid surface material registered with the U.S. Environmental Protection Agency to actively kill bacteria. The antibacterial properties work 24/7, never washing out or wearing away, making it the ideal choice where infection control is paramount. Our Copper Nickel range of ironmongery is manufactured using a 70-30 copper-nickel alloy, which makes the range tarnish-resistant and will not oxidize and patinate like pure copper. Note - only 'touch-point' items will be made from Copper Nickel. This includes Pull Handles, Push Plates, Lever Handles, Escutcheons and Bathroom Thumbturns. Where an ironmongery set is specified as Copper Nickel, all 'non-touch-point' items will be Stainless Steel. Please also note, Digi-Locks are not available in Copper Nickel.

Intumescent Jackets

Many ironmongery components will require 1mm or 2mm intumescent protection around the hardware in order to protect the cut-out in the door leaf in the event of a fire. These components are not listed in the ironmongery sets but the correct intumescent products are included automatically based on the fire rating of the door. This makes it simpler when selecting your ironmongery - you tell us what ironmongery set you want, and we take care of the intumescent if required!

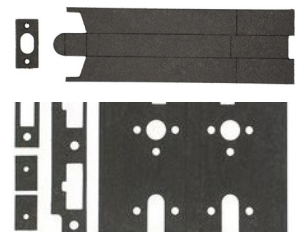

Fire Signage

Under building regulations, all fire doors must be fitted with mandatory fire signage. There are numerous types of mandatory signage, and the exact sign required depends on the type of door, and also depends on what other hardware is being fitted to the doorset. Mandatory fire signage is not listed in the ironmongery sets as this is required in order to meet building regulations, but it will automatically be included according to the fire rating of the doorset, and according to the other hardware items on the door.



Pivots

The **DSDA & DUDA** Door Systems require the doors to be hung on pivots rather than standard hinge in order to allow the door to swing in both directions. Where doors are NFR, a free-swing pivot will be used. We use a fully adjustable high quality pivot designed for commercial environments. Where doors are FD30 or FD60 – a Floor Spring will be used (see below)



Floor Springs

Where **DSDA & DUDA** Door Systems are FD30 or FD60, the doors must be fitted with a closing device – just like any other fire rated door. We use universal non-handed floor springs which conform to EN 1154. These are designed for door weights of up to 120kg. These Floor Springs also feature hydraulically fully controlled closing cycle and backcheck function.





Emergency Release Door Stop



All **DSDA and DUDA** Door Systems are supplied with Emergency Release Door Stops. These are designed to be fitted into the head or jamb of the frame and act as a door stop for the door to close. However, in the event of an emergency, the pin can be depressed allowing the door to open in reverse.

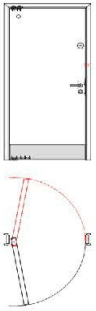

DSDA Ironmongery Sets (Dfendoor, Single Door, Double Swing, Ambulant WC)

Handle Type	Locking & Release	Closer Type	Image	Application / Description	Set No.	Set Contents
Lever Handle	Bathroom  & Emergency Release Stop 	Pivot 		Ambulant WC (Allows reverse opening in the event of an emergency)	017	Lever Handle, Thumbturn, Bathroom Lock, Floor Spring (if door is Fire Rated, Free Swing Pivot if NFR), Emergency Release Door Stop, Floor Door Stop, Kickplates

DUDA Ironmongery Sets (Dfendoor, Unequal Pair, Double Swing, Ambulant WC)

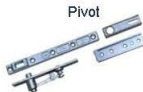
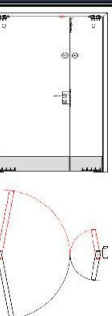
Handle Type	Locking & Release	Closer Type	Image	Application / Description	Set No.	Set Contents
Lever Handle	Bathroom  & Emergency Release Stop 	Pivot 		Ambulant WC (Allows reverse opening in the event of an emergency)	024	Lever Handle, Thumbturn, Bathroom Lock, Floor Spring (if door is Fire Rated, Free Swing Pivot if NFR), Emergency Release Door Stop, Floor Door Stops, Flush Bolt, Kickplates

Note: All sets will include in the relevant intumescent and fire signage based on the fire rating of the door. See notes on page 8

Additional PVC Protection – Kickplates

Whilst PVC encapsulated doors are arguably the most durable option for internal healthcare doorsets – some clients like to add additional PVC kickplates to the face of the doors in order to provide enhanced protection, and/or to provide a contrasting colour feature. PVC Kickplates are available flushed into the face of the door (providing flushed in PVC Edge Protectors are also fitted), or as surface mounted kickplates. The beauty of surface mounted PVC kickplates is that they are fully replaceable, and unlike Stainless Steel kickplates – there are no size restrictions on fire rated doors.

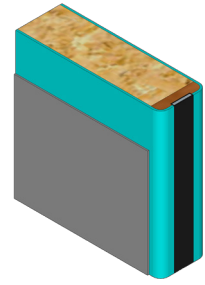

Additional PVC Protection – Edge Protectors

PVC Edge Protectors are often used where the door and frame are similar in colour, to provide a contrasting colour to one or both door edges. The Building Regulations Approved Document Part M (BS 8300-2:2018), states that the presence of doors, whether open or closed, should be apparent to visually impaired people through the careful choice of colour and material for the door and its surroundings. This document also states that all Internal doors should be identifiable and contrast visually with the surrounding wall and floor finishes, achieving at least 30 points LRV. PVC Edge Protectors are available in any of the colours listed above and are supplied flushed into the face of the door for infection control purposes, and in order to simplify the fitting of the ironmongery

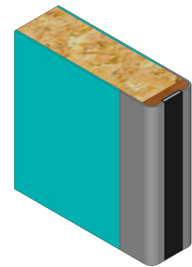

Fire & Smoke Seals

As standard, Intumescent Brush strips are fitted to all doors, and plain intumescent strips are used where two Brush strips would conflict – i.e. on the meeting stiles of a pair of doors. All strips are supplied in either Black or White, as standard.



Threshold Seals

No threshold seals are used on our **DSDA** or **DUDA** door systems.

Door Handings

Door handings refer to the side of the door where the pivots are when viewing the 'pull-side' of the door. (This applies to the normal opening direction of the door – not the opening direction when being opened in reverse). Unequal pairs refer to the large leaf



Overhead Panels

Not applicable to the **DSDA** or **DUDA** door systems.

Sidescreen Panels

Not applicable to the **DSDA** or **DUDA** door systems.

Air Transfer Grilles

Air movement in a building is important. Grilles are often fitted into walls and ceilings, but sometimes they need to be fitted in doors. However, fire and smoke travels wherever there's air movement! Our intumescent air transfer grilles create the perfect solution by expanding to form a solid block in the event of a fire, in order to stop fire spreading. Air transfer grilles are available on any of the **DSDA** or **DUDA** systems in NFR, FD30 or FD60 rating. (Note Air Transfer Grilles are not suitable for smoke rated doors – i.e. FD30s or FD60s.)



	Swing Type	Door Configuration	SYSTEM CODE	Durability	Warranty	Fire Ratings	Flush Glaze Available?	Priviglaze Available	Priviglaze+ Available	No. of Finishes	Additional PVC Protection	OHP Available	Sidescreen Available
Dfendoor	Single Swing	Single Door	DSS	Severe Duty	10 years	NFR, FD30, FD60	✓	✓	✓	24	✓	✓	✓
		Unequal Pair	DUS	Severe Duty	10 years	NFR, FD30, FD60	✓	✓	✓	24	✓	✓	✓
		Double Door	DDS	Severe Duty	10 years	NFR, FD30, FD60	✓	✓	✓	24	✓	✓	✓
	Double Swing	Single Door	DSD	Severe Duty	10 years	NFR, FD30, FD60	✓	✓	✓	24	✓	✓	✓
		Unequal Pair	DUD	Severe Duty	10 years	NFR, FD30, FD60	✓	✓	✓	24	✓	✓	✓
		Double Door	DDD	Severe Duty	10 years	NFR, FD30, FD60	✓	✓	✓	24	✓	✓	✓
	Ambulant WC (This Data Sheet)	Single Door	DSDA	Severe Duty	10 years	NFR, FD30, FD60				24	✓		
		Unequal Pair	DUDA	Severe Duty	10 years	NFR, FD30, FD60				24	✓		
	Lead Lined	Single Door	DLSS	Severe Duty	10 years	NFR, FD30, FD60	✓	✓	✓	24	✓		
		Unequal Pair	DLUS	Severe Duty	10 years	NFR, FD30, FD60	✓	✓	✓	24	✓		
		Double Door	DLDS	Severe Duty	10 years	NFR, FD30, FD60	✓	✓	✓	24	✓		
Lamdoor (limited door sizes available - Max leaf size =2100 x 950mm)	Single Swing	Single Door	LSS	Medium Duty	5 years	NFR, FD30, FD60				7		✓	✓
		Unequal Pair	LUS	Medium Duty	5 years	NFR, FD30, FD60				7		✓	✓
		Double Door	LDS	Medium Duty	5 years	NFR, FD30, FD60				7		✓	✓
	Double Swing	Single Door	LSD	Medium Duty	5 years	NFR, FD30, FD60				7		✓	✓
		Unequal Pair	LUD	Medium Duty	5 years	NFR, FD30, FD60				7		✓	✓
		Double Door	LDD	Medium Duty	5 years	NFR, FD30, FD60				7		✓	✓
	Double Swing Ambulant WC	Single Door	LSDA	Medium Duty	5 years	NFR, FD30, FD60				7			
		Unequal Pair	LUDA	Medium Duty	5 years	NFR, FD30, FD60				7			



For further information, contact us:

T 01420 543222

E sales@specialistdoorsolutions.com

Unit 1 Bordon Trading Estate, Old Station Way, Bordon, Hampshire GU35 9HH

specialistdoorsolutions.com